

Xiaomi 智能抽濕機使用說明書
Xiaomi Smart Dehumidifier User Manual



安全須知

- ⊘ 帶此標誌的內容，表示禁止行為。 ① 帶此標誌的內容，表示應該遵守。

⚠ 安全注意

如不嚴格遵守，可能導致人身傷害或死亡等嚴重事故。

- ⊘ • 抽濕機不宜由下述人群（包括兒童）使用：身體上、感覺上或精神上有缺陷者，或缺乏經驗和知識者。除非他們得到對其安全負責的人關於該項產品使用的監護或指導。
 - ⊘ • 不要擅自更換電源線或將電源線中途駁接，如果電源線損壞，為了避免危險，必須由製造商、其維修部或類似部門的專業人員更換。
 - ⊘ • 對抽濕機進行清潔時，請停止運行機器，並關閉電源開關。
 - ⊘ • 為了防止火災、爆炸或傷害，當附近可能有可燃性或腐蝕性氣體時，不得使用抽濕機。
 - ⊘ • 不要將抽濕機放置在熱源附近，否則可能會導致器件變形或引發火災。
 - ⊘ • 不要擅自修理、拆解、改裝或清潔內部器件，處置不當會導致漏水、觸電、火災等。需要修理時，請撥打服務電話。
 - ⊘ • 不要將手指、棍棒或其他物品伸到進風口或出風口中，否則可能會造成產品故障或損壞，甚至人身傷害。
 - ⊘ • 手濕時不要操作抽濕機、插拔電源線，以免造成觸電。
 - ⊘ • 不要用水直接清洗抽濕機或在可能會接觸到水的場所使用抽濕機，否則可能會導致觸電或火災。
 - ⊘ • 不可在抽濕機上放置有水的容器，如花瓶等，否則可能會導致觸電或火災。
 - ⊘ • 不要以插拔電源線的方式直接開關機器，否則可能會導致觸電或火災。
- ① 如果發現異常現象（如燒焦的氣味等），應立刻切斷電源，並撥打服務電話尋求解決方法。在此情況下仍繼續使用，會導致損壞、觸電、火災。
-

⚠ 使用注意

如不嚴格遵守，可能導致人身傷害或物品損壞等事故。

- ⊘ • 不要攀爬或坐靠在抽濕機上，否則可能會導致器件變形。
 - ⊘ • 不要讓抽濕機直吹植物或動物，否則可能會引起不良影響。
 - ⊘ • 不得將有明火的物體放在抽濕機的出風口，否則可能會因為燃燒不完全產生有毒氣體。
 - ⊘ • 不要遮擋抽濕機的進風口、出風口，否則可能會降低抽濕機使用性能或發生故障。
 - ⊘ • 長期不使用時，請關閉電源開關，將水箱清潔晾乾後裝回主機，整機通風放置兩天後再進行收納。
 - ⊘ • 抽濕機器內有壓縮機，須直立放置，如有傾倒或經長途運輸，請把機器至少直立放置12小時後再通電開機。
- ① • 請勿在洗衣間使用抽濕機。
- ① • 如果水管的周圍溫度低於零度，請勿連續排水。
 - ① • 請勿在地毯上拖動機器，否則可能發生傾倒的危險。
 - ① • 請將抽濕機放置於穩固的水平地面，否則可能會影響機器使用效果。
 - ① • 請經常清潔抽濕機空氣濾網，濾網髒堵可能會導致除濕效果降低。
 - ① • 請勿將機器靠在障礙物或牆上，機器周圍必須留有至少20公分的空間，出風口上方必須留有至少50公分的空間。
 - ① • 抽濕機在一個相對封閉的有效空間內使用方可達到最佳性能，使用機器時請關閉門窗以及其他通風裝置。

產品介紹

● 抽濕機各部位名稱

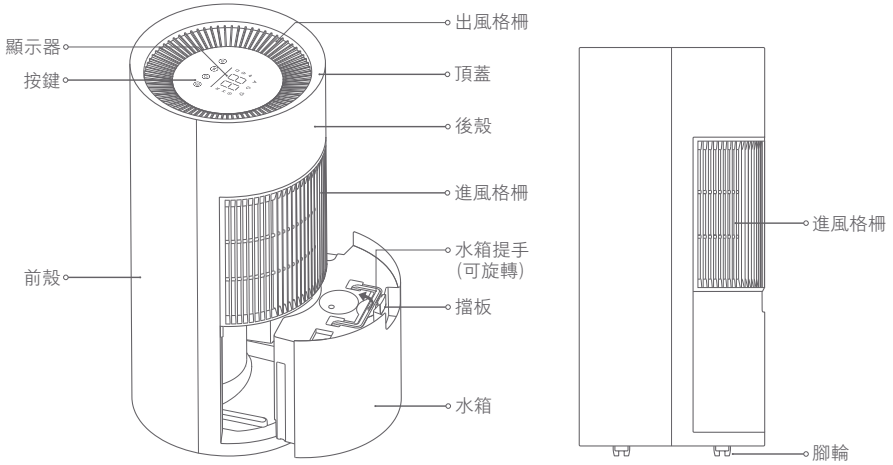

● 操作介面

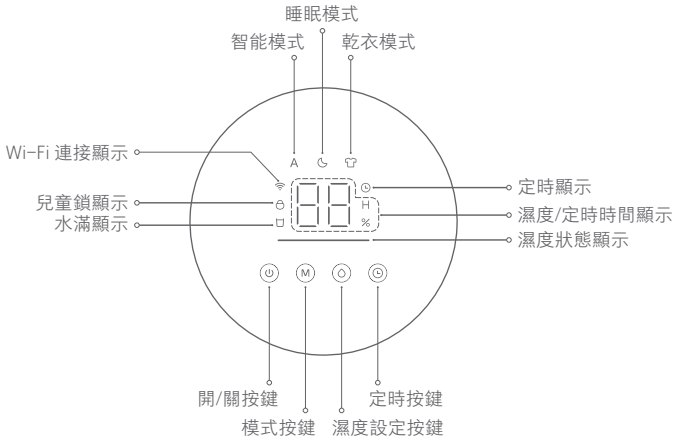

附註：機器外觀以實物為準。

使用

開/關按鍵

短按  鍵開啟或關閉抽濕機。

提示：本產品在開機後預設會進行40分鐘烘乾，烘乾結束後抽濕機關閉，烘乾過程中短按  鍵可強行開機。烘乾功能可在應用程式中關閉。

模式按鍵

開機狀態下，短按  鍵用於選擇智能、睡眠、乾衣模式，依次循環。



智能模式：抽濕機根據室內濕度與設定目標濕度，自動調整工作狀態，自動調節風速。

睡眠模式：抽濕機根據室內濕度與設定目標濕度，在低風速狀態下，自動調節啟停。

乾衣模式：抽濕機以高風速、強力除濕的方式持續運行，不可設定濕度。為了達到最佳的乾衣效果，建議衣服甩水後，在密閉房間內使用乾衣模式。

提示：抽濕機首次上電，預設為智能模式，目標濕度自動設定為50%。

本產品整體噪音較低，不同工作模式下，噪音差異不明顯，此屬正常現象。

濕度設定按鍵





開機狀態下，短按  鍵用於選擇濕度設定：40%→50%→60%→70%，依次循環。

定時按鍵



開機狀態下，短按  鍵用於選擇定時開機設定，定時精度為1小時： →  →  → ，依次循環。

選定到所需時間後5秒內不進行任何操作將自動預設設定成功，螢幕上顯示  圖示。

兒童鎖設定與解鎖

同時按住  和  鍵持續7秒，開啟兒童鎖功能。兒童鎖開啟時，螢幕上顯示  圖示，此時抽濕機不回應其他按鍵操作。再次同時按住  和  鍵持續7秒，關閉兒童鎖功能。

水滿保護

在運行狀態下，當水箱水位達到水箱上限保護刻度或者水箱裝配不到位時，機器會出現水滿保護，此時蜂鳴器會發出5次「嗒」的聲響，螢幕上水滿指示圖示  持續閃爍（亮0.5秒，滅0.5秒），除開/關按鍵外所有按鍵失效；水位恢復正常或水箱裝配恢復到位置時，水滿保護信號消除，螢幕上水滿指示圖示  消失。

重設 Wi-Fi

同時按住  和  鍵持續7秒重設抽濕機的 Wi-Fi 連接。

聯網狀態提示

Wi-Fi 圖示	描述
慢閃	等待配網
快閃	正在聯網
長亮	已聯網

房間濕度狀態顯示

橙色：乾燥，相對濕度 < 30%；青色：舒適，30% ≤ 相對濕度 ≤ 70%；藍色：潮濕，相對濕度 > 70%。

自動除霜功能

抽濕機運行過程中，當機器出現冰霜覆蓋時，抽濕機會自動進入除霜工作狀態，壓縮機停止運轉，風機繼續運行直至化霜結束為止。機器處於除霜工作狀態時，螢幕上圖示閃爍，除霜結束後，螢幕上的圖示停止閃爍，機器進入正常運行狀態。

烘乾功能

抽濕機關機後，為加快機身內部水汽的蒸發，風扇會以睡眠模式狀態下的轉速繼續運行40分鐘，以達到烘乾效果。烘乾可降低潮濕環境滋生細菌的可能性，並確保開機後濕度感應器不受機器內部殘留水汽的影響而數值偏高，建議開啟。

連續排水

1. 握住水箱上部的扣手向外水平抽出水箱。

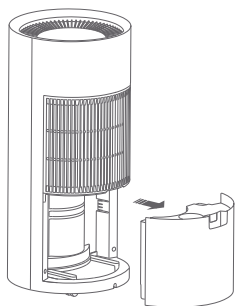

2. 取下水箱上的擋板，把擋板卡在水箱蓋上，以防丟失。

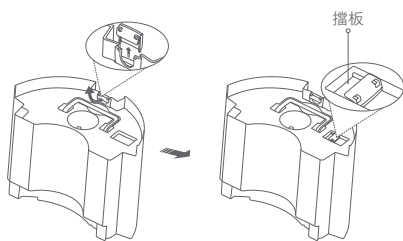

3. 連接排水軟管。

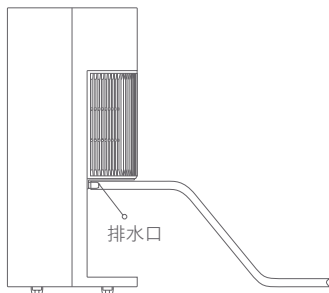

4. 裝回水箱，將排水軟管的另一端連接至下水道，此時抽濕機可以自動排水。

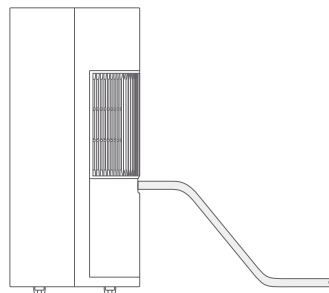

提示：使用連續排水時，排水軟管末端應低於抽濕機排水口，以確保回收水順暢排出，嚴禁高低不平及過度彎折。

連接米家APP

本產品已連接米家，可透過米家App操控，並與其他產品互聯互通。

掃描QR Code，下載並安裝米家App，已安裝米家App的用戶將直接進入裝置連接頁面。或在Google Play商店及Apple App Store搜尋「米家」，下載並安裝米家App。打開米家App首頁，在頁面右上角點擊「+」，根據App提示方式新增裝置。



623E5198



提示：

由於米家App的升級與更新，實際操作可能與本產品描述略有差異，請按照目前最新米家App版本指引進行操作。

維護與保養

△ 保養前請注意

- 清潔抽濕機前必須停機並斷開電源、不要弄濕抽濕機，否則可能會發生觸電危險。確保在任何情況下都不用水沖洗抽濕機。
- 不要使用揮發性液體（如稀釋劑、汽油等）擦拭抽濕機，否則可能會損壞抽濕機外觀。使用柔軟的乾布和沾有中性洗滌劑的濕布清潔抽濕機外殼。
- 定期清潔過濾網，以免灰塵覆蓋影響使用效果。在灰塵較多的環境中使用抽濕機時，清洗次數應相應增加。取下過濾網後，不要用手指觸摸殼體內的翅片部分，以免劃傷手指。

清潔抽濕機機身

抽濕機機身髒污時，使用45°C 以下的溫水將布浸濕，擰乾後輕擦髒污部分。

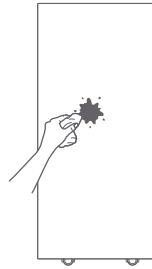

清潔過濾網

1. 握住水箱上部的扣手向外水平抽出水箱。

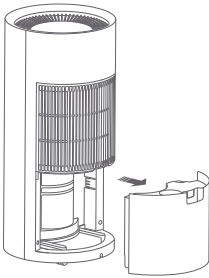

2. 取出進風格柵，之後取出內側的空氣過濾網。

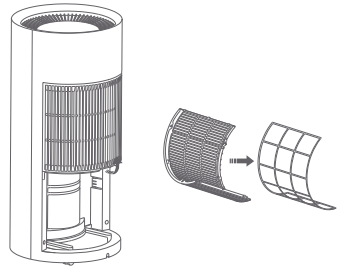

3. 用水漂洗或用吸塵器清理過濾網及進風格柵，過濾網很髒（如有油污）時，需用溶有中性洗滌劑的溫水（45°C 以下）清洗，然後放置於陰涼處晾乾。

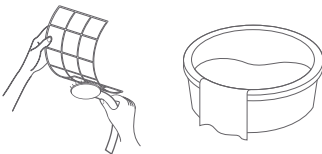

4. 將晾乾的過濾網裝好復位，重新裝好進風格柵及水箱。

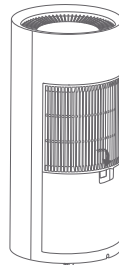

清潔水箱

1. 握住水箱上部的扣手向外水平抽出水箱。
2. 將水箱提手提起並旋轉60度左右（提手指示線到水平位置），向水箱提手脫出的方向輕微用力推壓，依次取出左右兩側的轉軸，直至提手脫出。

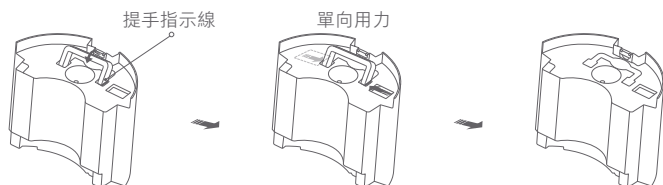

3. 扣住水箱右上方的倒水口用力，可輕鬆拆下水箱蓋。

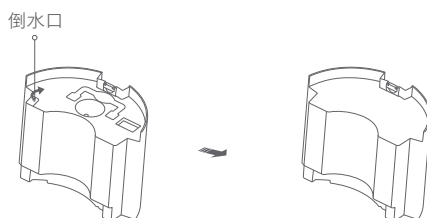

4. 將水箱清洗乾淨並晾乾，之後將水箱蓋和提手依次裝好，將水箱復位。

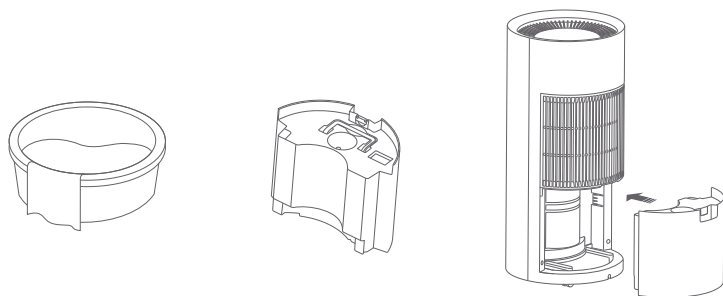

長期不使用時

- 關機後，請靜置兩天。
- 清潔主機、水箱及過濾網。
- 將抽濕機直立儲藏在乾燥通風處。
- 請將電源線彎曲成卷並用電源線紮帶綁好。
- 建議使用包裝袋將抽濕機裝好。

疑難排解

現象	原因及解決方法
抽濕機無法運行	<ul style="list-style-type: none">• 檢查是否停電。• 檢查電源插頭是否鬆脫。• 檢查水箱是否水滿或者水箱是否放置好。• 檢查是否使用了定時功能。
抽濕機除濕效果不佳	<ul style="list-style-type: none">• 過濾網可能因積塵過多導致堵塞。• 室內溫度可能低於5℃或高於35℃。• 檢查機器的濕度設定是否合適。• 檢查機器的進、出風口是否堵塞。• 檢查門窗是否打開。
運行時有異常的聲音	<ul style="list-style-type: none">• 檢查機器是否放置平穩。• 檢查過濾網是否堵塞。• 檢查是否是壓縮機啟動時的冷媒聲音。
抽濕機有輕微抖動現象	<ul style="list-style-type: none">• 抽濕機在開機或關機時，可能會出現輕微抖動，屬於正常現象。
抽濕機漏水	<ul style="list-style-type: none">• 檢查連續排水管是否鬆脫。• 檢查排水系統是否堵塞。

常見錯誤代碼

代碼	名稱	排除方法
C2	風機故障	關機，5分鐘後開機，如故障代碼多次出現，請聯絡售後服務中心。
C3	顯示板與主機板通訊故障	斷開電源後重新上電，如無法解決，請聯絡售後服務中心。
E1	管溫感溫包故障	關機，5分鐘後開機，如故障代碼多次出現，請聯絡售後服務中心。
E9	濕度感應器故障	關機，5分鐘後開機，如故障代碼多次出現，請聯絡售後服務中心。
H2	超載保護	檢查機器的進、出風口是否堵塞，重新開機後如故障代碼多次出現，請聯絡售後服務中心。
H6	缺氟保護	關機，5分鐘後開機，如故障代碼多次出現，請聯絡售後服務中心。

提示：故障代碼會顯示在機器顯示器上。

基本参数

- 除濕量在其所標定環境溫度、濕度時測得，隨著工況的變化而會有所變化。
 - 工作溫度範圍為5°C~35°C，若室溫超出此範圍，機器可能不工作。
 - 如參數資料有變更，則以產品銘牌的參數為準，恕不另行通知。
-

產品名稱：**xiaomi** 智能抽濕機

產品型號：CSJ0111DM

產品尺寸：Φ300 x 660 mm

產品淨重：13 kg

額定電壓：220~240 V~

額定頻率：50 Hz

風量：185 m³/h

抽濕量：11 公升/天 (26.7°C/60%相對濕度)

20 公升/天 (30°C/80%相對濕度)

輸入功率：200 W (26.7°C/60%相對濕度)

250 W (30°C/80%相對濕度)

額定輸入功率：300 W

輸入電流：0.9 A

額定輸入電流：1.3 A

噪聲：≤40 dB(A)

水箱容積：4.5 L

製冷劑：R134a/0.21 kg

使用環境溫度：5°C~35°C

熔斷絲規格：3.15 A/250 V

電源線規格：3 x 1.0 mm²

無線連接：Wi-Fi IEEE 802.11 b/g/n 2.4GHz

如需要詳細的電子說明書，請瀏覽 www.mi.com/global/service/userguide

聲明

隨著產品的技術更新，與本產品相同型號的產品使用說明書內容可能會有變更，更新部分恕不另行通知。

本說明書中展示的所有圖示僅用作示例說明用途，實際外觀請以所購買的產品為準。

由於產品不斷升級，部分參數可能有所變更，變更後的參數恕不另行通知，請以本產品銘牌參數為準。

本說明書相關條款解釋權歸小米通訊技術有限公司所有。

委託商：小米通訊技術有限公司
服務電話：852-30773620

製造商：浙江星月電器有限公司
(小米生態鏈企業)

地址：浙江省金華市永康市總部中心金品大廈二十四樓南側
本產品售後服務請查詢官網：www.mi.com/hk/service

說明書版本號：V1.0

Safety Instructions

- ⊘ This symbol indicates forbidden actions.
- ⓘ This symbol indicates actions that should be followed.



⚠ Safety Precautions

Failure to strictly follow the precautions may cause serious accidents such as personal injury or death.

- ⊘
 - Under normal use of condition, this equipment should be kept a separation distance of at least 20 cm between the antenna and the body of the user.
 - This appliance is not intended for use by persons (including children) with reduced physical, sensory or mental capabilities, or lack of experience and knowledge, unless they have been given supervision or instruction concerning use of the appliance by a person responsible for their safety.
 - This appliance can be used by children aged from 8 years and above and persons with reduced physical, sensory or mental capabilities or lack of experience and knowledge if they have been given supervision or instruction concerning use of the appliance in a safe way and understand the hazards involved.
 - Children shall not play with the appliance. Cleaning and user maintenance shall not be made by children without supervision.
 - Children should be supervised to ensure that they do not play with the appliance.
 - If the supply cord is damaged, it must be replaced by the manufacturer, its service agent or similarly qualified persons in order to avoid a hazard.
 - Before cleaning the dehumidifier, stop it from running and turn it off.
 - To prevent fire, explosion or injury, do not use the dehumidifier where there may be flammable or corrosive gases nearby.
 - Do not place the dehumidifier near a heat source, as this may result in deformation of the dehumidifier or fire.
 - Do not repair, disassemble, modify or clean the internal components by yourself, as improper handling may cause water leakage, electric shocks, or fire. When repairs are needed, please contact the after-sales service.
 - Do not poke fingers, sticks, or any other object into the air inlet or the air outlet, as this may result in product failure or damage, or even personal injury.
 - Do not operate the dehumidifier, or plug in or unplug the power cord with wet hands to prevent electric shocks.
 - Do not clean the dehumidifier directly with water or use the dehumidifier in places where it may come into contact with water, as this may result in electric shock or fire.
 - Do not place containers of water, such as vases, on top of the dehumidifier, as this may result in electric shock or fire.
 - Do not turn the dehumidifier on or off by plugging it in or unplugging it, as this may result in electric shock or fire.
 - This appliance contains only functional grounding connections.
- ⓘ If you notice anything unusual (e.g., smell of burning), you should immediately unplug the dehumidifier and contact the after-sales service for a solution. Continued use in such circumstances may result in damage, electric shock, or fire.

Usage Precautions

Failure to strictly follow the precautions may result in personal injury or damage to property.

-  • Do not climb or sit on the dehumidifier, as this may cause it to become deformed.
 - Do not allow the dehumidifier to blow directly onto plants or animals, as this may have adverse effects.
 - Do not place objects with open flames by the outlet of the dehumidifier, as this may generate toxic gases due to incomplete combustion.
 - Do not block the air inlet or the air outlet of the dehumidifier, as this may reduce the dehumidifier's performance or cause malfunctions.
 - When the dehumidifier is not used for a long period of time, disconnect it from the electrical outlet and empty the water tank. Dry the water tank thoroughly and reinstall it back into the dehumidifier. Then leave the dehumidifier for two days and put it away.
 - The compressor inside the dehumidifier must be kept upright. If the dehumidifier has been tipped over or transported for a long distance, stand it upright for at least 12 hours before turning it on.
-
-  • Do not use the dehumidifier in a laundry room.
 - If the temperature around the hose falls below zero, do not use the function of continuous water drainage.
 - Do not drag the dehumidifier across a carpet, as this may cause it to topple over.
 - Place the dehumidifier on a stable, level surface. Otherwise, its performance may be reduced.
 - Clean the dehumidifier's air filter regularly, as the performance of the dehumidifier may be reduced if the filter is dirty or blocked.
 - Do not place the dehumidifier against objects or walls. Make sure there must be at least 20 cm of clearance around the dehumidifier and at least 50 cm above its air outlet.
 - For optimal performance, the dehumidifier should be operated in enclosed spaces. Close doors and windows, and turn off other ventilating devices when using the dehumidifier.

Product Overview

Read this manual carefully before use, and retain it for future reference.

Components Description

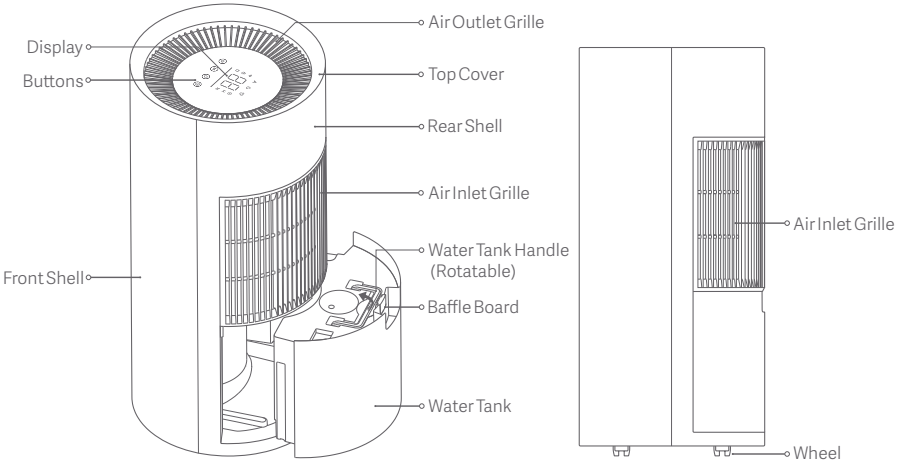

Display Instructions

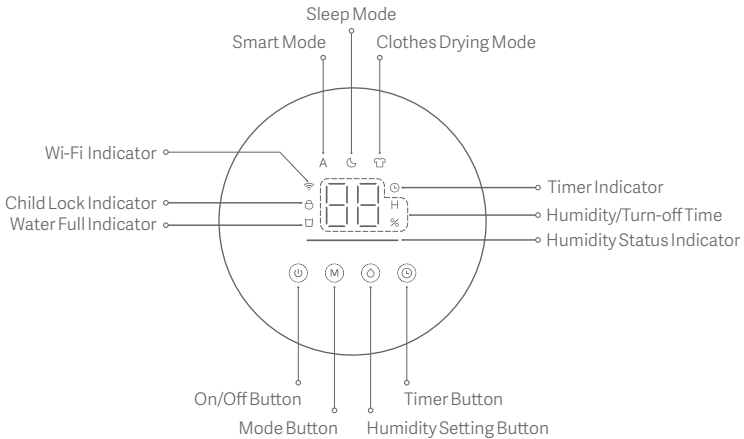

Note: Illustrations of product, accessories, and user interface in the user manual are for reference purposes only. Actual product and functions may vary due to product enhancements.

How to Use

On/Off Button

Press the button  to turn the dehumidifier on or off.

Note: The dehumidifier will dry for 40 minutes by default after being turned off. It will turn off automatically once it has finished drying, or you can press the button  during drying to turn it off manually. This function can be disabled in the app.

Mode Button

When the dehumidifier is on, press the button  to cycle through three modes of smart, sleep, and clothes drying.

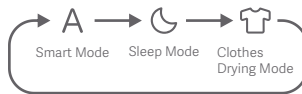

- Smart mode: The dehumidifier will automatically adjust its settings and fan speed based on the room's humidity level and the expected humidity that you set.
- Sleep mode: The dehumidifier will start and stop automatically at a low fan speed based on the room's humidity level and the expected humidity that you set.
- Clothes drying mode: The dehumidifier will run continuously at a high speed, delivering powerful dehumidifying performance. In this mode, the humidity cannot be set. For optimal drying effect, it is recommended to spin-dry the clothes first and then continue to dry clothes by using this mode in an enclosed room.







Notes:

- When the dehumidifier is turned on for the first time, the default mode is smart mode and the humidity is 50% by default.
- The dehumidifier is running very low noise, so the differences in noise level among the three modes are not obvious. This is normal.





Humidity Setting Button

When the dehumidifier is on, press the button  to cycle through humidity settings: 40%-50%-60%-70%.



Timer Button

When the dehumidifier is on, press the button  to cycle through the turn-off times:  →  →  →  hours. Once the desired turn-off time is selected with no operation for 5 seconds, the timer will automatically be set and the icon  will appear on the display.

Enabling/Disabling the Child Lock

Press and hold the buttons  and  simultaneously for 7 seconds to enable the child lock. Once it is enabled, the display will show the icon  and the dehumidifier will not respond to button operations. Press and hold the buttons  and  for 7 seconds again to disable the child lock.

Water Full Alert

When the dehumidifier is running, if the water tank gets too full or is not correctly installed, the dehumidifier will beep 5 times as an alert, and the water full indicator  will continuously blink (on for 0.5 seconds and off for 0.5 seconds). All buttons except for the on/off button cannot function. Once the water level in the tank returns to normal or the water tank is secured properly in place, the alert will stop and the water full indicator  will go out.

Resetting the Wi-Fi

Press and hold the buttons  and  simultaneously for 7 seconds to reset the Wi-Fi connection.

Wi-Fi Status Description

Wi-Fi Icon	Description
Blinks slowly	Awaiting connection
Blinks quickly	Connecting
Remains on	Connected

Humidity Status Indicator

- Orange: Dry, relative humidity < 30%.
- Cyan: Comfortable, $30\% \leq$ relative humidity \leq 70%.
- Blue: Humid, relative humidity > 70%.

Auto-defrost Function

When the dehumidifier is running, it will automatically defrost if it gets covered in frost. The compressor will stop operating and the fan will continue to run until the defrosting is complete. When the defrosting is in process, the icon  will blink on the display. Once the defrosting is finished, the icon will stop blinking and the dehumidifier will start running normally again.

Drying Function

Once the dehumidifier has been turned off, the fan will continue to run at the speed of the sleep mode for 40 minutes to speed up the water evaporation inside the dehumidifier. Drying can help reduce the possibility of bacteria buildup in a humid environment. Since the humidity sensor may be affected by residual water vapor inside the dehumidifier after the dehumidifier is turned off, drying can also ensure that the humidity value detected by the sensor is not higher than the actual humidity. It is recommended to enable this function.

Continuous Water Drainage

1. Pull the water tank out horizontally from the opening at the top of the water tank.

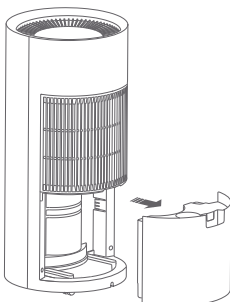

2. Remove the baffle board from the water tank, and secure it onto the cover so the board does not get lost.

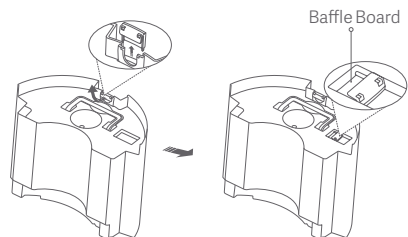

3. Connect the drainage hose to the water outlet.

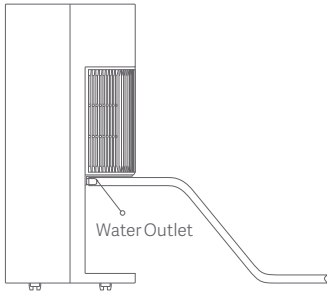

4. Reinstall the water tank and connect the other end of the drainage hose to the drainage. Then the dehumidifier can drain water automatically.

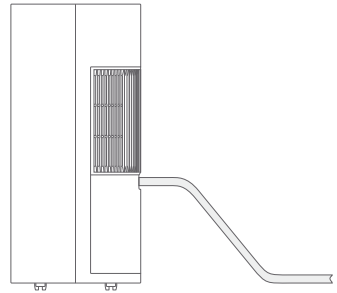

Note: When using the function of continuous water drainage, the end of the drainage hose should be lower than the dehumidifier's water outlet to ensure the water can be drained away successfully. Make sure the hose hangs down smoothly without being wavy and is not overly bent.

Connect with Mi Home/Xiaomi Home App

This product works with Mi Home/Xiaomi Home app *. Use the Mi Home/Xiaomi Home app to control your device, and to interact with other smart home devices.

Scan the QR code to download and install the app. You will be directed to the connection setup page if the app is installed already. Or search "Mi Home/Xiaomi Home" in the app store to download and install it.

Open Mi Home/Xiaomi Home app, tap "+" on the upper right, and then follow prompts to add your device.

* The app is referred to as Xiaomi Home app in Europe (except for Russia). The name of the app displayed on your device should be taken as the default.



623E5198



Note: The version of the app might have been updated, please follow the instructions based on the current app version.

Care & Maintenance

⚠ Maintenance Precautions

- Before cleaning the dehumidifier, you must turn it off and disconnect it from the electrical outlet, so as to avoid electric shock. Do not rinse the dehumidifier with water under any circumstances.
- Do not use any volatile liquids (e.g., thinner and gasoline) to wipe the dehumidifier, as this may damage its appearance. Use a soft dry cloth and a wet cloth with neutral detergent to clean the dehumidifier's shell.
- Clean the filter regularly to avoid the dehumidifier's performance being reduced by the buildup of dust. If the dehumidifier is used in a dusty environment, cleaning should be carried out more frequently. After removing the filter, do not touch the finned parts inside the dehumidifier with your fingers to avoid cutting yourself.

Cleaning the Dehumidifier

If the dehumidifier gets dirty, soak a cloth with water under 45°C, wring it out and use it to gently wipe over the dirty area.

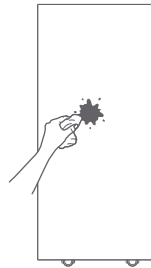

Cleaning the Filter

1. Pull the water tank out horizontally from the opening at the top of the water tank.

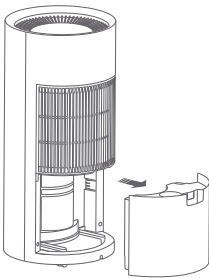

2. Remove the air inlet grille, and then remove the inner air filter.

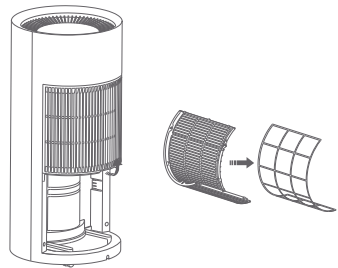

3. Rinse the filter and the air inlet grille with water or use a vacuum cleaner to clean them. If the filter is particularly dirty (such as with oil stains), you should use warm water (below 45°C) with neutral detergent to clean it, and then dry it in a cool place.

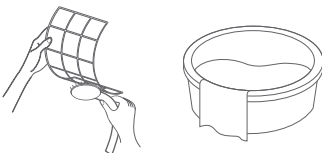

4. Reinstall the fully dried filter, the air inlet grille, and the water tank.

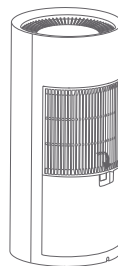

Cleaning the Water Tank

1. Pull the water tank out horizontally from the opening at the top of the water tank.
2. Lift the handle of the water tank and rotate it about 60° until the indicator line on the handle is horizontal. Slightly apply force on the handle in the direction shown by the arrows. Take the left and right shafts of the handle out one at a time to remove the handle.



3. Remove the cover of the water tank from the spout on the top right corner of the water tank.

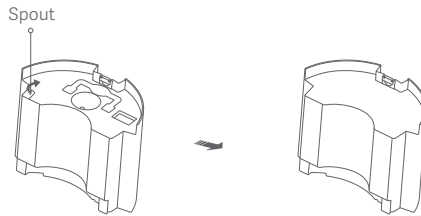

4. Clean the water tank and fully dry it. Then attach the cover and the handle to the water tank, and reinstall the water tank.

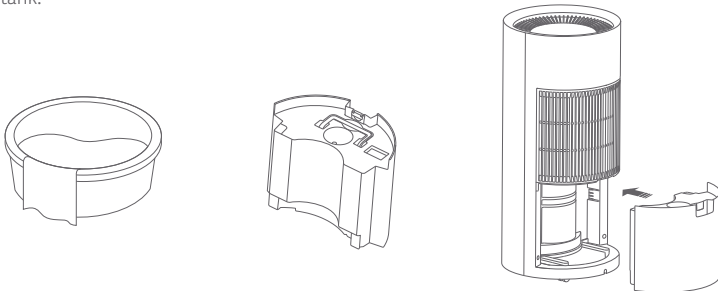

When Not Use for a Long Time

- Turn the dehumidifier off and leave it to stand for two days.
- Clean the dehumidifier, the water tank, and the filter.
- Store the dehumidifier upright in a dry and well-ventilated place.
- Coil up the power cord and secure it with a cable tie.
- It is recommended to store the dehumidifier in packaging.

Troubleshooting

Issue	Cause and Solution
The dehumidifier cannot work.	<ul style="list-style-type: none">• Check whether there is a power failure.• Check whether the power plug has become loose.• Check whether the water tank is full or has been installed incorrectly.• Check whether the timer function is being used.
The dehumidifier does not work well.	<ul style="list-style-type: none">• The filter may have become clogged with dust.• The indoor temperature may be below 5°C or above 35°C.• Check whether the humidity is set appropriately.• Check whether the dehumidifier's air inlet or air outlet is blocked.• Check whether the windows and the doors are open.
The dehumidifier makes unusual sounds when running.	<ul style="list-style-type: none">• Check whether the dehumidifier is on a flat surface.• Check whether the filter is blocked.• Check whether the refrigerant makes sound when the compressor is turned on.
The dehumidifier shakes slightly.	<ul style="list-style-type: none">• When the dehumidifier is turned on or off, it may shake slightly. This is normal.
The dehumidifier leaks water.	<ul style="list-style-type: none">• Check whether the drainage hose has become loose.• Check whether the drainage system is blocked.

Common Error Codes

Code	Description	Solution
C2	Fan error	Turn the dehumidifier off for 5 minutes and then turn it on again. If the error code appears multiple times, please contact the after-sales department.
C3	Communication error between display and motherboard	Disconnect the dehumidifier from the electrical outlet then reconnect it to the electrical outlet. If the issue persists, please contact the after-sales department.
E1	Pipe temperature sensor error	Turn the dehumidifier off for 5 minutes and then turn it on again. If the error code appears multiple times, please contact the after-sales department.
E9	Humidity sensor error	Turn the dehumidifier off for 5 minutes and then turn it on again. If the error code appears multiple times, please contact the after-sales department.
H2	Overload protection	Check whether the dehumidifier's air inlet or air outlet is blocked. Turn the dehumidifier on again, and if the error code appears multiple times, please contact the after-sales department.
H6	Fluoride deficiency protection	Turn the dehumidifier off for 5 minutes and then turn it on again. If the error code appears multiple times, please contact the after-sales department.

Note: The error code will appear on the dehumidifier's display.

Specifications

- The dehumidifier's capacity is measured at the calibrated ambient temperature and humidity. The results may vary due to the actual operating conditions.
- The dehumidifier's operating temperature range is from 5°C to 35°C. If the indoor temperature is out of this range, the dehumidifier may not be able to work.
- If the specifications change, the details on the dehumidifier's nameplate shall prevail without notice.
- For detailed e-manual, please go to www.mi.com/global/service/userguide

Name: Xiaomi Smart Dehumidifier

Model: CSJ0111DM

Item Dimensions: Φ 300 × 660 mm

Net Weight: 13 kg

Rated Voltage: 220–240 V~

Rated Frequency: 50 Hz

Air Flow Rate: 185 m³/h

Dehumidifying Capacity: 11 L/d (26.7°C/60% RH)
20 L/d (30°C/80% RH)

Power Input: 200 W (26.7°C/60% RH)
250 W (30°C/80% RH)

Rated Power Input: 300 W

Current: 0.9 A

Rated Current: 1.3 A

Noise: ≤ 40 dB(A)

Water Tank Capacity: 4.5 L

Refrigerant: R134a/0.21 kg

Operating Temperature: 5°C to 35°C

Fuse: 3.15 A/250 V

Power Cord: 3 × 1.0 mm²

Wireless Connectivity: Wi-Fi IEEE 802.11 b/g/n 2.4 GHz

*Radio Frequency and Radio Transmission Power

RF Specification: 2.4 G Wi-Fi

Operation Frequency: 2412–2472 MHz

Maximum Output Power: < 20 dBm

Disposal and recycling information



All products bearing this symbol are waste electrical and electronic equipment (WEEE as in directive 2012/19/EU) which should not be mixed with unsorted household waste. Instead, you should protect human health and the environment by handing over your waste equipment to a designated collection point for the recycling of waste electrical and electronic equipment, appointed by the government or local authorities. Correct disposal and recycling will help prevent potential negative consequences to the environment and human health. Please contact the installer or local authorities for more information about the location as well as terms and conditions of such collection points.

Manufactured for: Xiaomi Communications Co., Ltd.

Manufactured by: Zhejiang Xingyue Electric Equipment Co., Ltd.
(a Mi Ecosystem company)

For further information, please go to www.mi.com/hk/service

Address: South Side, 24th Floor, Jinpin Building, Headquarters
Center, Yongkang City, Zhejiang Province, China